

# EMISSION SYSTEM LOCATION INDEX [ZJ, Z6, LF]

B3E011601074W01

## Engine Compartment Side

ZJ, Z6

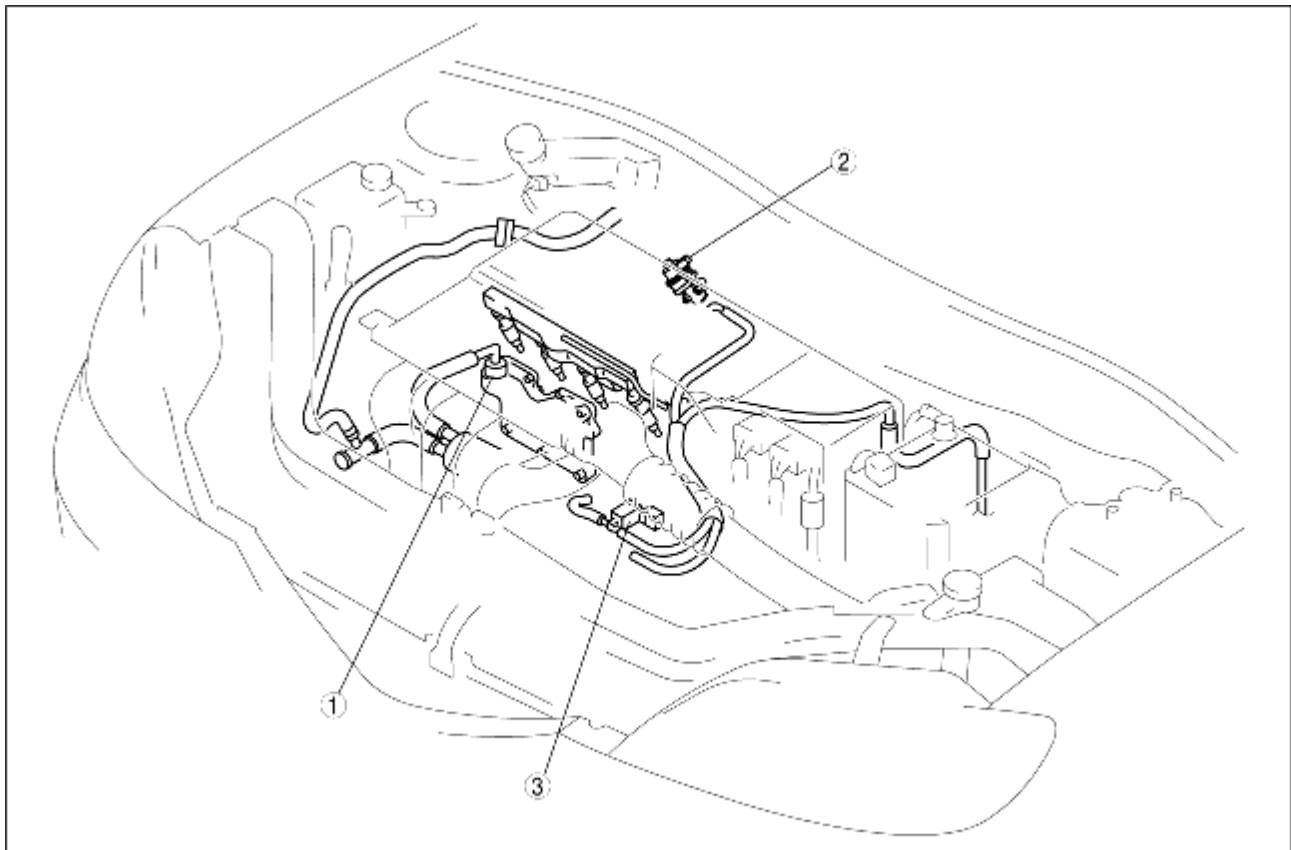

B3E0116W002

1	Positive crankcase ventilation (PCV) valve (See <a href="#">POSITIVE CRANKCASE VENTILATION (PCV) VALVE INSPECTION [ZJ, Z6, LF].</a> )
2	EGR valve (See <a href="#">EGR VALVE REMOVAL/INSTALLATION [ZJ, Z6].</a> ) (See <a href="#">EGR VALVE INSPECTION [ZJ, Z6, LF].</a> )
3	Purge solenoid valve (See <a href="#">PURGE SOLENOID VALVE REMOVAL/INSTALLATION [ZJ, Z6].</a> ) (See <a href="#">PURGE SOLENOID VALVE INSPECTION [ZJ, Z6, LF].</a> )

LF

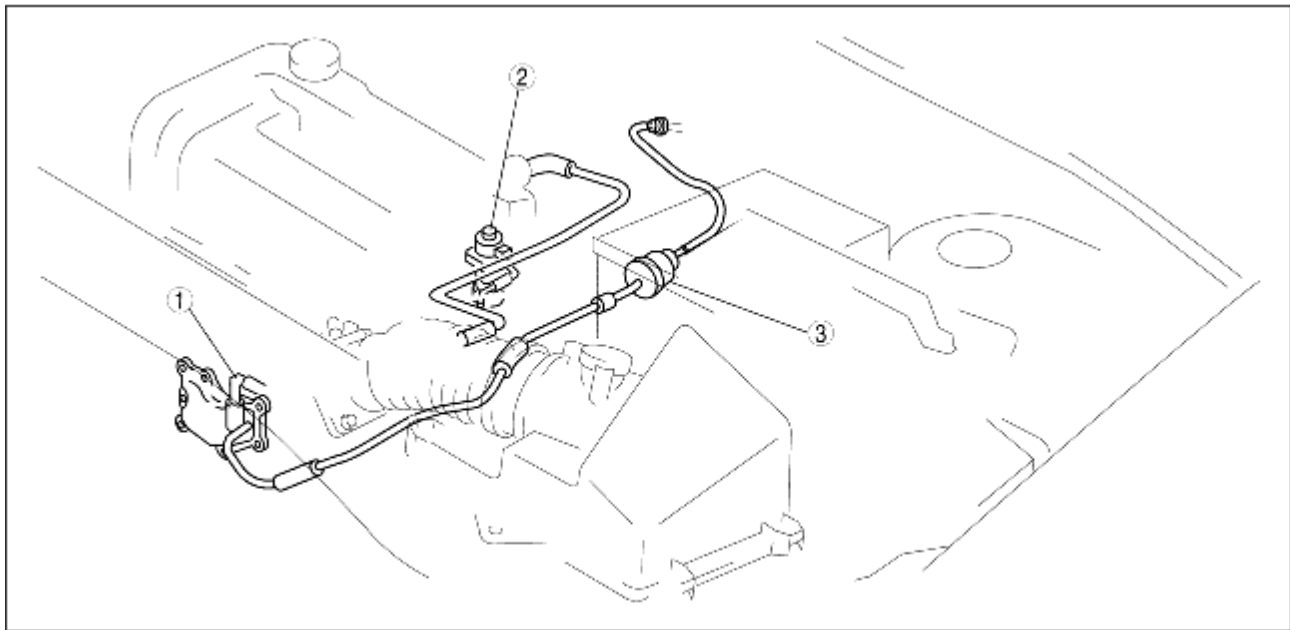

B3E0116W001

1	Positive crankcase ventilation (PCV) valve (See <a href="#">POSITIVE CRANKCASE VENTILATION (PCV) VALVE INSPECTION [ZJ, Z6, LF].</a> )
2	EGR valve (See <a href="#">EGR VALVE REMOVAL/INSTALLATION [LF].</a> ) (See <a href="#">EGR VALVE INSPECTION [ZJ, Z6, LF].</a> )
3	Purge solenoid valve (See <a href="#">PURGE SOLENOID VALVE REMOVAL/INSTALLATION [LF].</a> ) (See <a href="#">PURGE SOLENOID VALVE INSPECTION [ZJ, Z6, LF].</a> )

## Fuel Tank Side

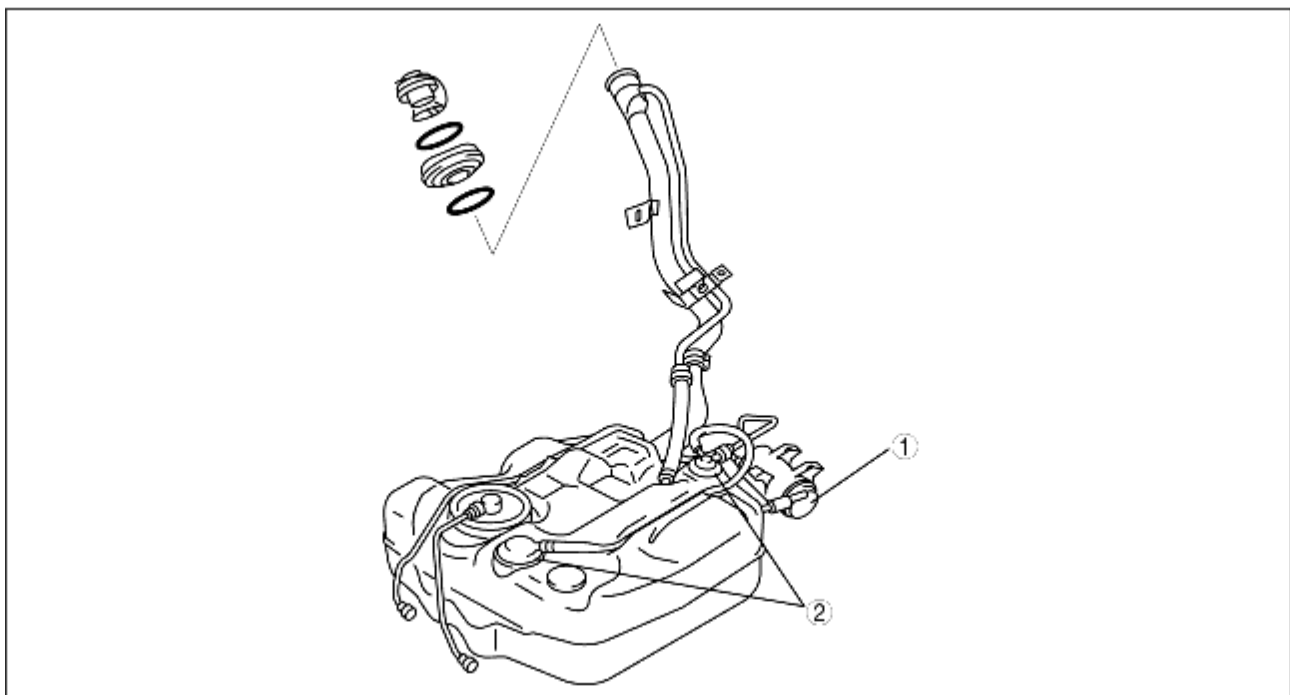

B3E0116W003

1	Charcoal canister (See <a href="#">CHARCOAL CANISTER REMOVAL/INSTALLATION [ZJ, Z6, LF].</a> ) (See <a href="#">CHARCOAL CANISTER INSPECTION [ZJ, Z6, LF].</a> )
2	Rollover valve (See <a href="#">ROLLOVER VALVE REMOVAL/INSTALLATION [ZJ, Z6, LF].</a> ) (See <a href="#">ROLLOVER VALVE INSPECTION [ZJ, Z6, LF].</a> )